

SPECIFICATIONS

MODEL NUMBER		EB-L730U		EB-L630SU	
SKU Number		V11HA25040		V11HA29040	
Projection Technology		RGB liquid crystal shutter projection system (3LCD)			
Specifications of Main Parts					
LCD	Size	0.67" (C2 Fine)			
	Resolution	WUXGA			
	Aspect Ratio	16:10			
Projection Lens	Type	Optical Zoom (Manual) / Focus (Manual)		No optical zoom / Focus (Manual)	
	F-Number	1.50 – 1.70		1.70	
	Focal Length	20 – 31.8 mm		11.76 mm	
	Zoom Ratio	1.0 - 1.60		1.0 - 1.35 (Digital Zoom)	
Lightsource	Throw Ratio	1.35 – 2.20 (Wide - Tele)		0.80 – 1.07 (Wide - Tele)	
	Type	Laser Diode			
	Life <sup>1</sup>	20,000 hours (Normal) / 30,000 hours (Extended)			
Screen Size (Projected Distance)					
Zoom: Wide		50" - 500" [1.44 - 14.76 m]		50" - 200" [0.85 - 3.49 m]	
Zoom: Tele		50" - 500" [2.35 - 23.84 m]		N/A	
Brightness <sup>2</sup>					
White Light Output (Normal / Extended)		7,000lm / 4,900lm		6,000lm / 4,200lm	
Colour Light Output (Normal)		7,000lm		6,000lm	
Contrast Ratio					
		Over 2,500,000:1			
Internal Speaker(s)					
Sound Output		10W Monaural			
Keystone Correction					
Projection Orientation		360° Free			
Vertical / Horizontal		±30° / ±30°			
Connectivity					
Analog RGB Input	D-Sub 15Pin	2			
	HDMI	2 (HDCP 2.3)			
Digital Input	HDBaseT	1 (HDCP 2.3)			
	Stereo Mini Jack	2			
Audio Input	USB Type A	2 [Port1 for PC Free, Firmware Update, Copy OSD Settings; Port2 for 5V/2A power supply only, no USB function]			
	USB Type B	1 (For Mouse, Keyboard, Control, Firmware Update)			
Control I/O	RS-232C	D-Sub 9pin x 1			
	D-Sub 15Pin	1			
Analog Video Output	HDMI	1 (HDCP 2.3)			
	Stereo Mini Jack	1			
Audio Output	Wired LAN	RJ45 x 1 (100Mbps)			
	Wireless	Built-in			
Network	Optional Wireless	ELPAP11			
	Wireless LAN (In-Built) and Screen Mirroring				
Supported Speed for Each mode		Infrastructure: IEEE 802.11b (2.4GHz): 11 Mbps <sup>3</sup> , IEEE 802.11g (2.4GHz): 54 Mbps <sup>3</sup> , IEEE 802.11n (2.4GHz): 72.2 Mbps <sup>3</sup> , IEEE 802.11a (5GHz): 54 Mbps <sup>3</sup> , IEEE 802.11n (5GHz): 150 Mbps <sup>3</sup> , IEEE 802.11ac (5GHz): 325 Mbps <sup>3</sup> Access Point (Wi-Fi Direct): IEEE 802.11g (2.4GHz): 54 Mbps <sup>3</sup> , IEEE 802.11n (2.4GHz): 72.2 Mbps <sup>3</sup> , IEEE 802.11a (5GHz): 54 Mbps <sup>3</sup> , IEEE 802.11n (5GHz): 150 Mbps <sup>3</sup> , IEEE 802.11ac (5GHz): 325 Mbps <sup>3</sup>			
Supported Mode		Infrastructure, Access Point (Wi-Fi Direct)			
Supported Security Type		Infrastructure: OPEN (WPA2/WPA3-PSK/ WPA2/WPA3-EAP) Supported EAP Type: PEAP, PEAP-TLS, EAP-TLS, EAP-Fast Access Point (Wi-Fi Direct): WPA2-PSK (AES)			
Wireless LAN (Using Optional ELPAP11)					
Supported Speed for Each mode		Access Point (Wi-Fi Direct): IEEE 802.11g (2.4GHz): 54 Mbps <sup>3</sup> , IEEE 802.11n (2.4GHz): 72.2 Mbps <sup>3</sup> , IEEE 802.11a (5GHz): 54 Mbps <sup>3</sup> , IEEE 802.11n (5GHz): 150.0 Mbps <sup>3</sup> , IEEE 802.11ac (5GHz): 325Mbps <sup>3</sup> Access Point (Wi-Fi Direct) Access Point (Wi-Fi Direct): WPA2-PSK (AES)			
Supported Mode		Access Point (Wi-Fi Direct): WPA2-PSK (AES)			
Supported Security Type					
Operating Temperature					
Single Use		Low Altitude (0 - 2,286m/7,500ft): 0 - 45 °C <32 - 113 °F> High Altitude (Over 2,286m/7,500ft to 3,048m/10,000ft): 0 - 40 °C <32 - 104 °F> 20% - 80% Humidity, No Condensation			
		Low Altitude (0 - 2,286m/7,500ft): 0 - 40 °C <32 - 104 °F> High Altitude (Over 2,286m/7,500ft to 3,048m/10,000ft): 0 - 35 °C <32 - 95 °F> 20% - 80% Humidity, No Condensation			
Multi-projection Use		Over 1,500m/4,921ft with High Altitude Mode: 0 - 3,048m (0 -10,000ft)			
		Yes			
		8 seconds (Epson Logo); Warm-up Period: 30 sec			
Quick Start-Up					
		Less than 5 seconds (Display)			
Cool Down Period					
		Instant Off			
Air Filter	Type	Electrostatic Filter			
	Maintenance Cycle <sup>4</sup>	20,000 hours (Normal) / 30,000 hours (Extended)			
Power Supply Voltage					
		100 - 240 V AC ±10%, 50/60 Hz			
Power Consumption (220 - 240V)					
Laser Diode On (Normal / Extended)		345 W / 258W			
Standby (Normal / Eco)		2.0W / 0.3W			
Dimension Excluding Feet (D X W X H)					
		304 x 440 x 122 mm			
Weight		Approx. 8.4kg		Approx. 8.4kg	
Fan Noise (Normal / Eco)		38dB / 27dB			

<sup>1</sup> Lamp life will vary depending upon mode selected, environmental conditions and usage. Lamp brightness decreases over time.  
<sup>2</sup> Colour brightness (colour light output) and white brightness (white light output) will vary depending on usage conditions. Colour light output measured in accordance with IDMS 15:4; white light output measured in accordance with ISO 21118.  
<sup>3</sup> These modes and actual data throughputs depend on supported wireless mode of source devices and/or environment conditions.  
<sup>4</sup> When used in the general office environment (the amount of floating dust: 0.04 - 0.2 mg/m<sup>3</sup>). Based on the Epson's in-house test results.

**Supplied Accessories**  
Power Cable: 3m  
HDMI Cable: 1.8m  
Remote Control: Yes, with Alkaline AA Battery  
Cable cover  
User Guide

**Optional Accessories**  
Air Filter: ELPAF56  
Wireless LAN unit: ELPAP11  
Ceiling Mount: ELPMB22  
HDBaseT Transmitter: ELPHD01  
Safety Wire Set: ELPWR01  
Wireless Presentation System: ELPWP10, ELPWT01

EB-L730U



EB-L630SU



©2021 Epson Singapore Pte Ltd. All Rights Reserved. Reproduction in part or in whole, without the written permission from Epson, is strictly prohibited. EPSON and EXCEED YOUR VISION are registered trademarks of Seiko Epson Corporation.

All other product names and other company names used herein are for identification purposes only and are the trademarks or registered trademarks of their respective owners.

Epson disclaims any and all rights in those marks. Projected images shown herein are simulations. The actual product design and contents may vary. Specifications are subject to change without notice and may vary between countries. Please check with local Epson offices for more information.

Apple, iPad and iPhone are trademarks of Apple Inc., registered in the U.S. and other countries. App Store is a service mark of Apple Inc.

Android is a trademark of Google Inc.

Dealer's Stamp

Information correct at time of printing.  
Printed April 2021

BUSINESS PROJECTORS  
EB-L520U/L630U/L630SU/L730U



COMPACT PROJECTION  
SOLUTION FOR ALL YOUR  
BUSINESS NEEDS.



A power-packed solution for business, education, as well as projection signage and entertainment.

Epson's versatile and compact EB-L730U series projectors are loaded with endless possibilities to project vivid and sharp images of up to 7,000 lumens<sup>3</sup> to your audience. Features such as center-lens placement, 360° installation, and a wide range of connectivity translates to a flexible and performance-focused projection solution to suit all your needs.

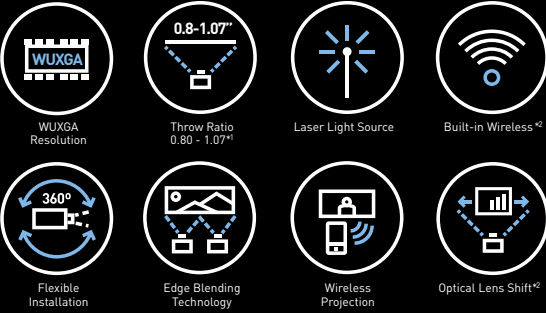

IT'S IN THE DETAILS.



Superb Image Quality

High brightness projection of up to 7,000 lumens<sup>3</sup> with laser light source and WUXGA resolution.

Compact & Flexible

Lightweight yet durable body with a myriad of installation options.

Seamless Connectivity

Enjoy convenience in projection via wireless connections without troublesome settings.

<sup>\*1</sup> For EB-L630SU. <sup>\*2</sup> Except for EB-L520U. <sup>\*3</sup> For EB-L730U.



# Massive and Brilliant. Stunning images beyond FULL HD.

Immerse in a stimulating and dynamic viewing experience with WUXGA resolution. Captivate your audience in lectures and meetings, impress your customers in stores, and maximise your reach at larger venues.

**Superb Resolution**  
WUXGA, 1920x1200

**High Brightness**  
Up to 7,000 lumens<sup>\*1</sup>

**Large Screen Size**  
Up to 500”<sup>\*2</sup>

**High Contrast Ratio**  
Over 2,500,000:1

**Laser Light Source**  
Up to 20,000<sup>\*3</sup>  
maintenance free hours



## Fascinate more with super-resolution

Project detailed and crisp images with the Image Enhancement function. With a few simple steps, deliver enthralling, clear projections and level up your presentations.



With super-resolution



Without super-resolution

## Save both your wallet and the environment

Without the need for lamp replacements and lower power consumption than its peers, enjoy higher savings while saving the earth with Epson's laser projectors. Do more with your maintenance-free laser projector, which runs on approximately 20,000 hours<sup>\*3</sup> of laser light source.

### Maintenance period of laser and lamp<sup>^</sup>

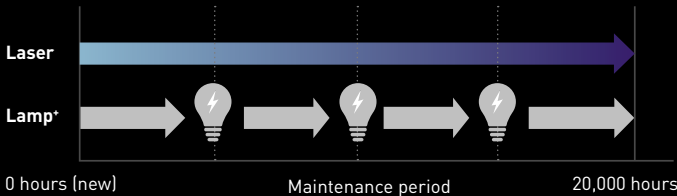

### Eco Features

- Uses just 0.3W of power in standby mode
- Projector optics employ lead-free lenses
- Unpainted plastic housing reduces the environment impact
- The flame retardants used in the plastic housing does not contain chlorine or bromine
- Laser light technology\* eliminates the need for lamp replacements

<sup>\*1</sup> For EB-L730U. Brightness for EB-L630U is 6,200 lumens, EB-L630SU is 6,000 lumens, EB-L520U is 5,200 lumens.

<sup>\*2</sup> Except EB-L630SU. Maximum screen size for EB-L630SU is 200 inch.

<sup>\*3</sup> 20,000H life for Laser light source: Approximate time until brightness decreases 50% from first usage. Measured by acceleration test assuming use of 0.04 - 0.20 mg/m3 of particulate matter. Time varies depending on usage conditions and environments. Replacement of parts other than the light source may be required in a shorter period.

<sup>+</sup> Compared with other conventional lamp projector that has lamp life of 5,000 hours.

<sup>^</sup> Approximate time until brightness decreases 50% from first usage. Measured by acceleration test assuming use of 0.04 - 0.20 mg/m<sup>3</sup> of particulate matter. Time varies depending on usage conditions and environments.



# Efficiency meets Flexibility. Fuss-free installation and operation.

With a wide range zoom of up to 1.6x zoom ratio<sup>\*1</sup> and flexible 360° installation, you can fit the compact Epson laser projector even in the tightest spaces, without compromising image quality. Alongside its versatile connectivity, maximise efficiency in meeting rooms and enhance the experience in retail storefronts.

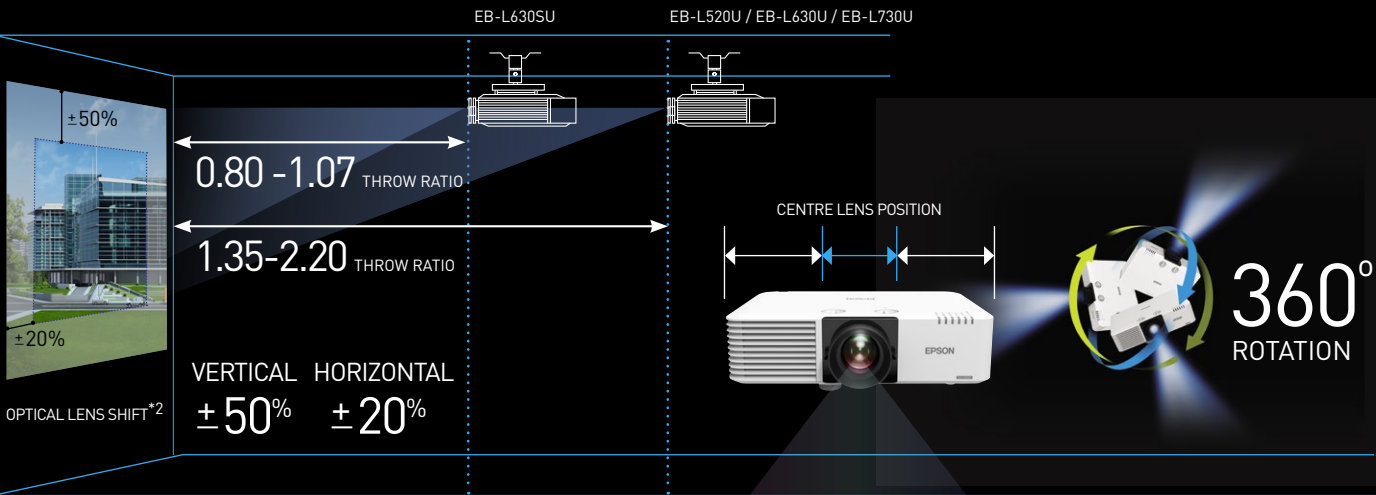

**Wide Range Zoom & Lens Shift**  
Up to 1.6x zoom ratio<sup>\*1</sup>

**Short Throw Capability<sup>\*3</sup>**  
80" screen at 1.38m  
Perfect for tight spaces

<sup>\*1</sup> Except EB-L630SU with no optical zoom, only 1.35x digital zoom.  
<sup>\*2</sup> Except for L520U which has no lens shift.  
<sup>\*3</sup> For EB-L630SU only.  
<sup>\*4</sup> HDBaseT can transmit Full HD video, audio and control at low cost through cat 5e/6 cables or higher, up to 100 metres. Ideal for large venues.

**Flexible Installation**  
Any direction in 360°

**Versatile Connectivity**  
2 x HDMI & HDBaseT for long distance transmission<sup>\*4</sup>



## Seamless multiple projection

Blend multiple projections seamlessly and easily into one large screen for maximum reach through Daisy-chaining with HDMI-out port. Correct any screen distortion quickly with the built-in geometric correction and edge blending function.



## Customisable content playback

Create personalised content easily onto any desired surface with the built-in playback function. Upload your content wirelessly or simply connect and start projecting fuss-free. Ideal for projection signage at storefronts or places of interest.



Retail signages



Event signages



# Connectivity Reinvented.

## Seamless collaborations without hassle.

Reinvent how collaborations happen in your meeting rooms with the optional **ELPWP10 wireless presentation system**. No more messy cables, additional installations and confusing network settings. Connect up to six users and project up to 4 connected devices in one screen simultaneously for enhanced collaboration.



### Project wirelessly

With built-in wireless connectivity, easily share content from your smart devices or PC using the Epson iProjection app.

Schedule and edit your playlist, convert movie formats, and manage data directly through Epson Content Manager.



Connect up to six different users at any one time. Click on share screen and the screen will split automatically.

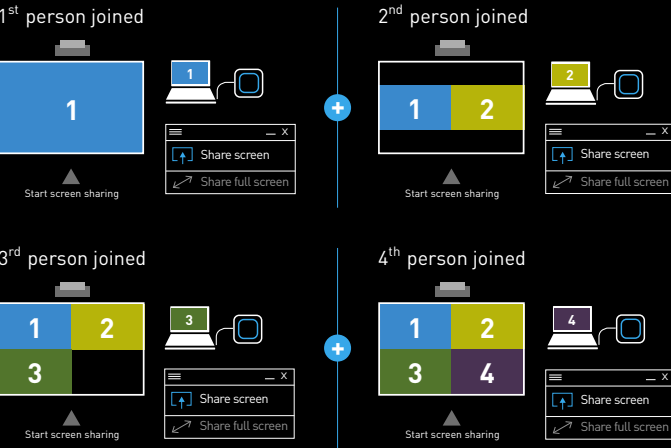

### Miracast support

With Miracast, you can now project Full HD videos and content wirelessly from compatible smart devices and laptops without additional software installation. With the screen mirroring\* support, projecting from your smart devices has never been easier.

\* If the Miracast function is activated, other network features will be disabled.



### SPECIFICATIONS

MODEL NUMBER		EB-L520U	EB-L630U
SKU Number		V11HA30040	V11HA26040
Projection Technology		RGB liquid crystal shutter projection system (3LCD)	
Specifications of Main Parts			
LCD	Size	0.67" (C2 Fine)	
	Resolution	WUXGA	
Aspect Ratio		16:10	
	Type	Optical Zoom (Manual) / Focus (Manual)	
Projection Lens	F-Number	1.50 – 1.70	
	Focal Length	20 – 31.8 mm	
Zoom Ratio		1.0 - 1.60	
	Throw Ratio	1.35 – 2.20 (Wide - Tele)	
Lightsource	Type	Laser Diode	
	Life <sup>1</sup>	20,000 hours (Normal) / 30,000 hours (Extended)	
Screen Size (Projected Distance)			
Zoom: Wide		50" - 500" [1.44 - 14.76 m]	
Zoom: Tele		50" - 500" [2.35 - 23.84 m]	
Brightness <sup>2</sup>			
White Light Output (Normal / Extended)		5,200lm / 3,640lm	6,200lm / 4,340lm
Colour Light Output (Normal)		5,200lm	6,200lm
Contrast Ratio			
		Over 2,500,000:1	
Internal Speaker(s)			
Sound Output		10W Monaural	
Keystone Correction			
Projection Orientation		360° Free	
Vertical / Horizontal		±30° / ±30°	
Connectivity			
Analog RGB Input	D-Sub 15Pin	2	
	HDMI	2 (HDCP 2.3)	
Audio Input	Stereo Mini Jack	2	
	USB Type A	1 (For PC Free, Firmware Update and Copy OSD Settings)	2 (1 Port for PC Free Firmware Update and Copy OSD Settings. Another port is for 5V/2A power supply, no USB function)
Control I/O	USB Type B	1 (For Mouse, K/B, Control and Firmware Update)	
	RS-232C	D-Sub 9pin x 1	
Analog Video Output	D-Sub 15Pin	1	
	HDMI	N/A	1 (HDCP 2.3)
Digital Video Output	Stereo Mini Jack	1	
	Wired LAN	RJ45 x 1 (100Mbps)	
Network	Built-in Wireless	N/A	Yes
	Optional Wireless	ELPAP11	
Wireless LAN (In-Built) and Screen Mirroring			
Supported Speed for Each mode		N/A	Infrastructure: IEEE 802.11b (2.4GHz): 11 Mbps <sup>3</sup> , IEEE 802.11g (2.4GHz): 54 Mbps <sup>3</sup> , IEEE 802.11n (2.4GHz): 72.2 Mbps <sup>3</sup> , IEEE 802.11a (5GHz): 54 Mbps <sup>3</sup> , IEEE 802.11n (5GHz): 150 Mbps <sup>3</sup> , IEEE 802.11ac (5GHz): 325 Mbps <sup>3</sup> Access Point (Wi-Fi Direct): IEEE 802.11g (2.4GHz): 54 Mbps <sup>3</sup> , IEEE 802.11n (2.4GHz): 72.2 Mbps <sup>3</sup> , IEEE 802.11a (5GHz): 54 Mbps <sup>3</sup> , IEEE 802.11n (5GHz): 150 Mbps <sup>3</sup> , IEEE 802.11ac (5GHz): 325 Mbps <sup>3</sup>
Supported Mode		N/A	Infrastructure, Access Point (Wi-Fi Direct)
Supported Security Type		N/A	Infrastructure: OPEN (WPA2/WPA3-PSK/ WPA2/WPA3-EAP) Supported EAP Type: PEAP, PEAP-TLS, EAP-TLS, EAP-Fast Access Point (Wi-Fi Direct): WPA2-PSK (AES)
Wireless LAN (Using Optional ELPAP11)			
Supported Speed for Each mode		Access Point (Wi-Fi Direct): IEEE 802.11g (2.4GHz): 54 Mbps <sup>3</sup> , IEEE 802.11n (2.4GHz): 72.2 Mbps <sup>3</sup> , IEEE 802.11a (5GHz): 54 Mbps <sup>3</sup> , IEEE 802.11n (5GHz): 150.0 Mbps <sup>3</sup> , IEEE 802.11ac (5GHz): 325Mbps <sup>3</sup> Access Point (Wi-Fi Direct) Access Point (Wi-Fi Direct): WPA2-PSK (AES)	
Supported Mode			
Supported Security Type			
Operating Temperature			
Single Use		Low Altitude (0 - 2,286m/7,500ft): 0 - 45 °C <32 - 113 °F> High Altitude (Over 2,286m/7,500ft to 3,048m/10,000ft): 0 - 40 °C <32 - 104 °F> 20% - 80% Humidity, No Condensation	
Multi-projection Use		Low Altitude (0 - 2,286m/7,500ft): 0 - 40 °C <32 - 104 °F> High Altitude (Over 2,286m/7,500ft to 3,048m/10,000ft): 0 - 35 °C <32 - 95 °F> 20% - 80% Humidity, No Condensation	
Operating Altitude			
		Over 1,500m/4,921ft with High Altitude Mode: 0 - 3,048m (0 -10,000ft)	
Direct Power On / Off			
		Yes	
Start-Up Period			
		8 sec (Epson Logo); Warm-up Period: 30 sec	
Quick Start-Up			
		Less than 5 seconds (Display)	
Cool Down Period			
		Instant Off	
Air Filter			
Type		Electrostatic Filter	
Maintenance Cycle <sup>4</sup>		20,000 hours (Normal) / 30,000 hours (Extended)	
Power Supply Voltage			
		100 - 240 V AC ±10%, 50/60 Hz	
Power Consumption (220 - 240V)			
Laser Diode On (Normal / Extended)		293 W / 223W	345 W / 258W
Standby (Normal / Eco)		2.0W / 0.3W	
Dimension Excluding Feet (D X W X H)			
		304 x 440 x 122 mm	
Weight			
		Approx. 7.7kg	Approx. 8.4kg
Fan Noise (Normal / Eco)			
		31dB / 23dB	38dB / 27dB

<sup>1</sup> Lamp life will vary depending upon mode selected, environmental conditions and usage. Lamp brightness decreases over time.

<sup>2</sup> Colour brightness (colour light output) and white brightness (white light output) will vary depending on usage conditions. Colour light output measured in accordance with IDMS 15:4; white light output measured in accordance with ISO 21118.

<sup>3</sup> These modes and actual data throughputs depend on supported wireless mode of source devices and/or environment conditions.

<sup>4</sup> When used in the general office environment (the amount of floating dust: 0.04 - 0.2 mg/m<sup>3</sup>). Based on the Epson's in-house test results.

Sales Enquiries  
800 120 5564

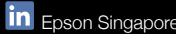
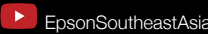
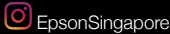

For latest specifications, visit [www.epson.com.sg/ecotank](http://www.epson.com.sg/ecotank) or call +65 800 120 5564.

Epson Singapore Pte Ltd  
Epson Customer Care Center

438B Alexandra Road, Block B Alexandra Technopark, #04-01/04, Singapore 119968. Tel: (65) 6586-5500  
100G Pasir Panjang Road, #01-09 Interlocal Centre, Singapore 118523. Epson Helpdesk: 800 120 5564. Please refer to [www.epson.com.sg/contact](http://www.epson.com.sg/contact) for opening hours.

#### Supplied Accessories

Power Cable: 3m  
HDMI Cable: 1.8m  
Remote Control: Yes, with Alkaline AA Battery  
Cable cover (Only for EB-L630U)  
User guide

#### Optional Accessories

Air Filter: ELPAF56  
Wireless LAN unit: ELPAP11  
Ceiling Mount: ELPMB22  
HDBaseT Transmitter: ELPHD01  
Safety Wire Set: ELPWR01  
Wireless Presentation System: ELPWP10, ELPWT01

EB-L520U



EB-L630U



©2021 Epson Singapore Pte Ltd. All Rights Reserved.  
Reproduction in part or in whole, without the written permission from Epson, is strictly prohibited.

EPSON and EXCEED YOUR VISION are registered trademarks of Seiko Epson Corporation.

All other product names and other company names used herein are for identification purposes only and are the trademarks or registered trademarks of their respective owners.

Epson disclaims any and all rights in those marks. Projected images shown herein are simulations. The actual product design and contents may vary. Specifications are subject to change without notice and may vary between countries. Please check with local Epson offices for more information.

Apple, iPad and iPhone are trademarks of Apple Inc., registered in the U.S. and other countries. App Store is a service mark of Apple Inc.

Android is a trademark of Google Inc.

Dealer's Stamp

Information correct at time of printing.  
Printed April 2021