

HOME THEATRE PROJECTORS

EpiqVision Series

EH-TW750/TW5820/TW7000

EH-TW7400/TW9400

EPSON
EXCEED YOUR VISION

androidtv

BRINGING DETAILS CLOSER TO YOU.



Dive right into a cinematic experience with Epson home entertainment series projectors.

Start watching your favourite shows with the built-in Android TV* and Chromecast* functions, complete with 4K image quality* of Epson home entertainment projectors. Enjoy movie marathons with less strain on the eyes, thanks to the gentler light reflection from the projector. Hosting movie nights with friends and family, or even binge watching your favourite dramas are now more enjoyable and convenient with Epson's range of home entertainment projectors.



IT'S IN THE DETAILS.

EpiqVision



Exceptional Image Quality

Watch as every scene come alive at stunning true-to-life quality, lit up in vivid colours.

Smart Media Player Function

Explore a world of unlimited entertainment with the built-in Android TV and Chromecast functions.

All-in-One Entertainment

Experience the perfect balance of visual and sound, encapsulated in a compact and stylish design.

* Selected models only. Projector's resolution and features vary with selected the model only.

Google, Google Home, Chromecast Built-in, Android TV and other related marks and logos are trademarks of Google LLC. 4K Enhancement Technology shifts each pixel diagonally to double Full HD resolution. Resolution is Full HD in 3D Mode.

A world of endless
entertainment awaits.

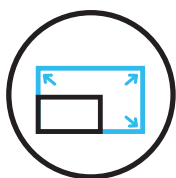

Flexible Screen Size

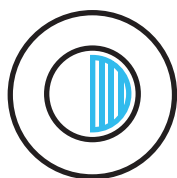

High Contrast Ratio

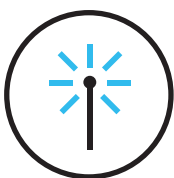

Laser Light Source*

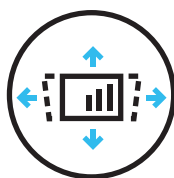

Lens Shift*



High Dynamic Range
(HDR)*



Android TV*



Built-in Speaker*



Horizontal Keystone
Adjuster*



Fuss Free set up



Smart Device
Wireless*

*Selected models only.

High definition Stunning image quality

It is no longer impossible to recreate that cinematic adventure in your own home with Epson's range of home projectors. Enjoy a truly captivating, detail-packed experience right from the comfort of your couch.



Plug-and-play Fuss-free set up

All you need is to plug in the power and your entertainment begins. Home entertainment is made more accessible and fuss-free with Epson's EpiqVision projectors, which come ready with built-in Android TV function.*

*Selected models only.

Truly flexible Project however wherever

Our stylish and compact home entertainment projectors are designed with the aim to blend in with the aesthetics of your room easily. With flexible screen sizes and keystone correction functions, you can now place the projector anywhere in your living room and still enjoy a perfect vivid projection.





Up close and personal

Bringing the actions closer to you with a bigger viewing screen, you can also stream to your heart's content with Android TV* now. Indulge in high contrast videos that bring forth a vivid viewing experience, enjoy your favourite shows without compromising on its quality whenever you are.



EH-TW750



EF-100B



EF-11



EF-12

EpiqVision Mini



Lightweight and Portable

As light as 1.2kg*, you now have the flexibility and convenience to bring the projector around the house, setting it up at any corner of your living space, and start watching the latest shows with your family and friends.



Get Connected Virtually

Simply start up your projector and begin video conferencing with no additional fuss. Conduct virtual calls with your friends and family by simply connecting your USB webcams**.



*Weight reference for EpiqVision MiniEF-11. **For EpiqVision Mini EF-12. Check compatible webcam listing on our website.

Brilliant and Sharp HDR10-Compatible

Except EH-TW750 and EF-11

Compatible with High Dynamic Range content, revel in crisp, detailed, and realistic images with enhanced details on your Epson ultra lifestyle projectors. Now you can enjoy an optimal viewing experience with prime picture quality for all your favorite shows.



With HDR Function

Without HDR Function

Cinematic Sound Experience with Built-in Yamaha Speaker

EpiqVision Mini EF-12 Only

Party as if you are there in person! Immerse in rich audio with the built-in Yamaha speaker, or use it as a standalone bluetooth speaker for your music while you chill.



sound by YAMAHA

Get more done with voice control on **androidtv**

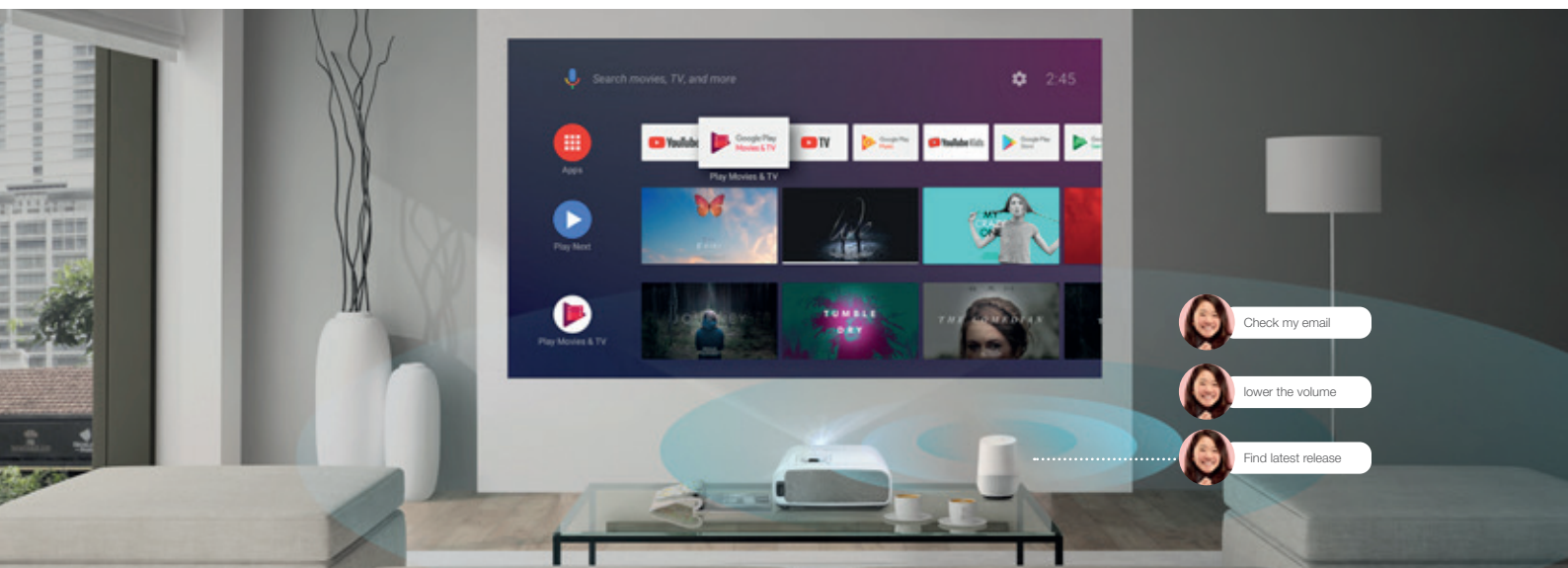

Press the **mic button** on the remote to get started

Explore a plethora of entertainment possibilities with the Android TV and Chromecast built-ins. With the intuitive integrated UI and Voice Control function**, you can now do more with Google Assistant. Simply connect to the Wi-Fi and your favourite content is just a voice command away.



Unlimited entertainment

Start a new drama, binge-watch your favourite movies, or stream the latest hits simply with a voice command.

Plan your day

Manage your calendar, flight information, daily commute and more with your smart projector.

Wealth of information

Learn more about the shows you are watching. Ask about your favourite movies, actors, or even get the latest scoring status for your favourite teams.

Seamless control at home

Adjust the temperature, lighting, home security and more, simply with your voice via compatible smart home devices.

Chromecast built-in

Google, Google Home, Chromecast Built-in, Android TV and other related marks and logos are trademarks of Google LLC. Chromecast is available for iOS or Android devices, Mac or Windows computer or Chromebook. Available for selected model. **Voice control is applicable to Android TV only.



Vibrant, Dynamic and Performance.

WORLD'S SMALLEST 3LCD LASER PROJECTOR*

EpiqVision Mini EF-100B



EpiqVision | RESOLUTION **WXGA** | SUPPORT BLUETOOTH AUDIO

UP TO **150"** | **2000** | VERTICAL & HORIZONTAL | **5W**
SCREEN SIZE | LUMENS | KEYSTONE | MONO SPEAKERS
ADJUSTMENT

*Research is done by Futuresource Consulting Limited, for 3LCD laser projectors with brightness of more than 500 lumens (as of 15 May 2019).

VERSATILE HOME ENTERTAINMENT PROJECTOR

EH-TW750



BUILT-IN WIRELESS | RESOLUTION **Full HD 1080p**

UP TO **300"** | **3400** | A U T O | **2W**
SCREEN SIZE | LUMENS | VERTICAL KEYSTONE | MONO SPEAKERS
ADJUSTMENT

WORLD'S SMALLEST 3LCD LASER PROJECTOR^

EpiqVision Mini EF-11



EpiqVision | RESOLUTION **Full HD 1080p**

UP TO **150"** | **1000** | A U T O | **1.5W**
SCREEN SIZE | LUMENS | VERTICAL KEYSTONE | MONO (2-WAY)
ADJUSTMENT | SPEAKERS

^Survey conducted by FutureSource Consulting Limited, for 3LCD laser projectors of more than 500lm in brightness, as of 22nd Oct, 2020.

WORLD'S SMALLEST 3LCD LASER PROJECTOR^ WITH ANDROID TV

EpiqVision Mini EF-12



EpiqVision | RESOLUTION **Full HD 1080p** | SUPPORT BLUETOOTH AUDIO

UP TO **150"** | **1000** | A U T O | **5W**
SCREEN SIZE | LUMENS | SCREEN | STEREO SPEAKERS
ADJUSTMENT

POWERED BY **androidtv** sound by **YAMAHA**

^Survey conducted by FutureSource Consulting Limited, for 3LCD laser projectors of more than 500lm in brightness, as of 22nd Oct, 2020.



Aesthetically pleasing no matter where you place it

Take your home viewing experience to the next level with Epson's Android TV ready line up*. Chill and stream endless entertainment contents online using Android TV from the comfort of your living room.



EH-TW5820



EH-TW7000

EpiqVision Ultra



EH-LS300B



EH-LS500B



Immersive and Frameless Large Sized Display

Maximize your on-screen entertainment with these feature-packed projectors, providing a frameless capability by breaking image size constraints. Your best alternative for home entertainment, projecting up to a 500-inch[^] screen size – much larger than what a conventional TV screen can provide.



Accessories that Complement ELPSC35 ALR Screen

For EpiqVision Ultra EH-LS300B & EH-LS500B

Bask in a cinematic experience right at home with 4K PRO-UHD² content on the ELPSC35 ALR Screen. With the ambient light rejecting ability, be impressed by the vibrant and realistic images with better contrasts and deeper blacks enhanced for your viewing pleasure.



Well Lighted Environment Dark Room Environment

[^]For EH-TW7000. ¹Based on 40-inch Laser TV x4. ²Applicable to EH-LS500BSMP.

Flexible Placement Optimal Placement

These sleek and compact projectors blend in seamlessly anywhere in your living space. Choose a projector that fits your requirement from the wide range of choices.



Standard Screen's Throw distance

Plug-and-Play Quick Start-Up

For EH-LS300B and EH-LS500B

You no longer have to wait to boot your EpiqVision series projectors up to begin watching your favourite shows. With the shorter start-up time compared to a traditional TV set-up, enjoy your favourite shows with a simple click on the remote.

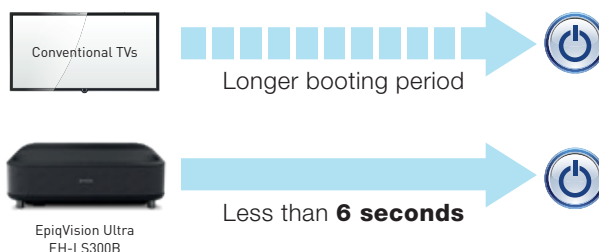

Fine-tune your sound experience with **YAMAHA** speaker

EpiqVision Ultra EH-LS300B Only



Bask in a multi-dimensional true sound with 3D surround, designed with YAMAHA's unique DSP processing technology – AudioEngine™. Striking a careful balance and delivering controlled beams of sound, you can now immerse in spectacularly powerful and supreme sound quality, regardless of whether it is a clear acoustic sound or rich bass music.

Choose the most suitable music mode based on the content you are playing:



STUDIO
For Music



STADIUM
For Sports



CONCERT
For Live Music



KARAOKE
For Karaoke



TV
For Broadcasting



THEATRE
For Movie

Flexible, Immersive Projection.

SMART FULL-HD 3D HOME THEATRE PROJECTOR

EH-TW5820



Chromecast built-in

HDMI™ V1.4

RESOLUTION



UP TO **300"**
SCREEN SIZE

2700
LUMENS

VERTICAL &
HORIZONTAL
KEystone
ADJUSTMENT

10W
MONO SPEAKERS

POWERED BY

androidtv

FULL-HD 3D HOME THEATRE PROJECTOR

EH-TW7000



HDMI™ V2.2

RESOLUTION



UP TO **500"**
SCREEN SIZE

3000
LUMENS

VERTICAL &
HORIZONTAL
KEystone
ADJUSTMENT

Easy Out-of-the-box set-up.
User friendly and easy to install.

SMART FULL-HD LASER PROJECTION TV

EpiqVision Ultra EH-LS300B



Chromecast built-in



EpiqVision Ultra

RESOLUTION



UP TO **120"**
SCREEN SIZE
@ JUST **0.70m**

3600
LUMENS

MOTION
SENSOR
LASER LIGHT
SAFETY

UP TO **20W**
SOUND OUTPUT
INCL. 1x WOOFER

POWERED BY

androidtv

sound by **YAMAHA**

4K PRO-UHD LASER PROJECTION TV

EpiqVision Ultra EH-LS500B



Chromecast built-in

EpiqVision Ultra

RESOLUTION



UP TO **130"**
SCREEN SIZE
@ JUST **0.58m**

4000
LUMENS

VERTICAL &
HORIZONTAL
KEystone
ADJUSTMENT

10W x2
STEREO
SPEAKERS

POWERED BY

androidtv

ULTRA EXPERIENCE PROJECTORS



Dynamic realism in every scene

Be it hosting a movie night or gaming with friends, enjoy cinematic experiences like never before. Build your very own home theatre and bring images to life with the 4K PRO-UHD display.



EH-TW7400



EH-TW9400



High-definition Images 4K PRO-UHD*

Epson 4K PRO-UHD projectors use our proprietary, an advanced pixel-shifting resolution-enhancement technology, to display native 4K content. Expect an exceptional 4K experience with Wide Color Gamut, HDR High Dynamic Range, and 100% Balanced Color Brightness.

Exceptional Brilliancy Ultra-wide Colour Gamut

The ultra-wide colour gamut increases the range of lifelike colour, while the high contrast ratio delivers deep blacks for defined detail in the shadows.



Zoom 300%



Full-HD



4K Pro-UHD



Zoom 300%



*4K Enhancement Technology shifts each pixel diagonally to double Full HD resolution. Resolution is Full HD in 3D Mode.

Control Your Viewing Motorised Lens

Equipped with motorised lens, the Epson home projectors allow up to 10 preset positions for zoom, focus and lens shift at both standard projections and wide cinema ratios. Easily change the aspect ratio to fit the type of content you are viewing for the optimal viewing experience.



16:9

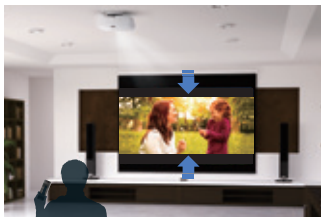

2.35:1 Cinema Scope Size

Revealing The Best Digital Image Processor

Fitted with a powerful processor that faithfully reproduces the source material the way it was intended to be shown, enjoy smooth tonal transitions thanks to realtime 12-bit analog-to-digital video processing. Presenting a spectacular visual performance, the processor eliminates banding, blocking, and other compression artifacts.



Without enhancement



Enhanced with Digital Image Processor

Breathtaking Contrast with **HDR** (High Dynamic Range)



SDR (Standard dynamic range)



HDR (High dynamic range)

Embrace brilliant colours and sharper images with the enhanced High Dynamic Range (HDR) function. You can adjust the brightness and gradation of projected images with greater detail and accuracy, thanks to the wider HDR10* parameter range and 18Gbps support, even for 4K/60p* HDR contents.

The “Auto” settings under the improved HDR user interface will “automatically” detect and switch between SDR, HDR10* and Hybrid Log Gamma (HLG)* settings.



Phenomenal Brilliance.

HIGH DYNAMIC 4K PRO-UHD HOME THEATRE PROJECTOR

EH-TW7400



200,000:1
Contrast Ratio

RESOLUTION 4K PRO-UHD 

UP TO **300"**
SCREEN SIZE

2400
LUMENS

POWERED
LENS SHIFT

Compact design for easy ventilation.

Designed with the air intake and exhaust at the front so that you can easily install them even in narrow spaces.

HIGH DYNAMIC 4K PRO-UHD HOME THEATRE PROJECTOR

EH-TW9400



1,200,000:1
Contrast Ratio

RESOLUTION 4K PRO-UHD 

UP TO **300"**
SCREEN SIZE

2600
LUMENS

POWERED
LENS SHIFT

Flexible installation with Optical Lens Shift

The wide lens shift range provides exceptional installation flexibility, allowing you to position your projector at any point in the room.

Unleash the potentials with the different Colour Modes

Calibrated to suit your viewing environment and contents, discover the possibilities with different colour modes.



Dynamic mode

Enjoy vivid image quality during the day without dimming the lights.



Cinema mode

Indulge in an authentic cinematic experience in the comfort of your home.



3D cinema

Bring your videos to life with 3D projections right at home.



OTHER FEATURES

Wide Range of Connectivity

Home entertainment is now made more accessible than ever! Epson's own range of projectors allows integrated support for multiple connection methods including HDMI connection to suit a wide range of entertainment devices.

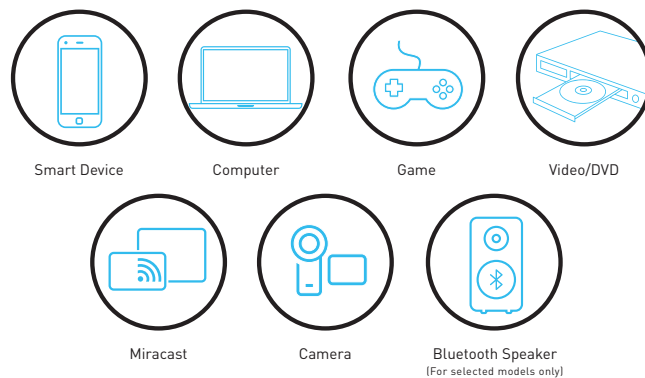

Compact Design for Easy Ventilation

The sleek and compact designs of Epson's home entertainment projectors allow you to easily install them even in the narrowest of spaces. With air intake valves positioned at the front, you will no longer have to worry about ventilation.

Optional Wireless Projection*

Projecting high contrast, vivid images smoothly is made convenient with the wireless transmission feature in our projectors. With the optional Wi-Fi adaptor[^] and the iProjection app, you can now project images directly from Android and Apple iOS smart devices, PCs and even laptops.

* Except EpiqVision Mini EF-11 and EF-12, EH-TW5820 and EpiqVision Ultra EH-LS300B.
[^] Except for EH-TW750.

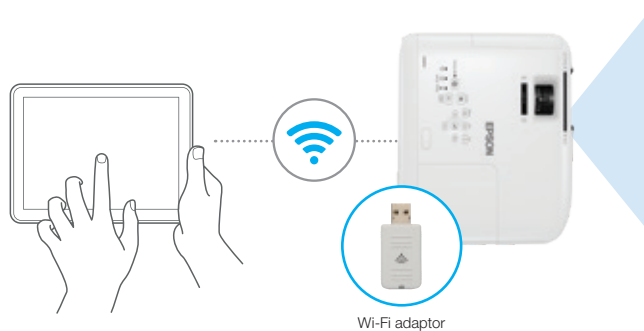

PROJECTOR WISHES COME TRUE.

EPSON 3LCD PROJECTORS

1-CHIP PROJECTORS



**TRUE
BRIGHTNESS**



WHITE 3000 LUMENS



COLOUR 3000 LUMENS



WHITE 3000 LUMENS



COLOUR 430 LUMENS**



**TRUE
COMFORT**



LIGHT
SOURCE

PRISM



LIGHT
SOURCE

ROTATING
COLOUR WHEEL



**TRUE
REALISM**



WIDER
COLOUR
RANGE



SMALLER
COLOUR
RANGE

**TRUE
COLOURS**

Brighter, vivid projection from Epson.



IT'S IN THE DETAILS.

With 3LCD panels, every projection gives you spectacular true colours.

Find out more at www.epson.com.sg/truecolours

* Leading Epson business and education projectors vs. leading 1-chip DLP® projectors, selected according to NPD data as of July 2015. Based on U.S. research conducted by Radius Research.

** These lumen statistic can be found at www.colorlightoutput.com.

1 Color brightness(color light output) in brightest mode, measured by a third-party lab in accordance with IDMS 15.4. Color brightness will vary depending on usage conditions. Top-selling Epson 3LCD projectors versus top-selling 1-chip DLP® projectors based on NPD sales data for May 2017 - April 2018.

2 Gamut volume in brightest mode, measured by a third-party lab in 3D in the CIE L*a*b* coordinate space. Top-selling Epson 3LCD projectors versus top-selling 1-chip DLP® projectors based on NPD sales data for May 2017 - April 2018.

SPECIFICATIONS

MODEL NUMBER		EpiqVision Mini EF-100B	EH-TW750
Projection Technology		RGB liquid crystal shutter projection system	
Specification of Main Parts			
LCD	Size	0.59" (C² Fine)	0.61" wide panel (C² Fine)
	Native Resolution	WXGA	1080p
Projection Lens	Type	No Optical Zoom / Focus (Manual)	Optical Zoom (Manual) / Focus (Manual)
	F-Number	1.58	1.58 – 1.7
Lightsource	Focal Length	13.53 mm	14.06 – 16.82 mm
	Zoom Ratio	1 – 1.35 (Digital Zoom)	1 – 1.20
	Throw Ratio	1.04 – 1.4 (Wide – Tele)	1.02 – 1.23 (Wide – Tele)
	Type	Laser Diode	Lamp: 210W UHE
	Life*1	Normal: 12,000 / Extended: 20,000 hours	Normal: 6,000 / Eco: 12,000 hours
Screen Size (Projected Distance)			
Zoom: Wide		30" to 150" [0.65 to 3.41 m]	30" – 300" [0.67 to 6.86 m]
Zoom: Tele		22" to 111" [0.65 to 3.41 m]	30" – 300" [0.81 to 8.28 m]
Standard Size		60" screen 1.34 to 1.81 m	60" screen 1.35 to 1.64 m
Brightness*2			
Colour Light Output		2,000 lm	3,400 lm
White Light Output (Normal / Eco)		2,000 lm / 1,000 lm	3,400 lm / 2,200 lm
Contrast Ratio		Over 2,500,000:1	16,000:1
Internal Speaker(s)			
Sound Output		5W Monoaural (with enclosure)	2 W Mono x 1
Geometric Correction			
Keystone	Vertical	±45°	±30°
	Horizontal	±40°	±30°
Quick Corner		Yes	
Connectivity			
Analog Input	D-Sub 15pin	N/A	1 (Blue)
	Composite	N/A	RCA x 1 (Yellow)
Digital Input	HDMI	1	2
	Audio In	N/A	RCA White x1, Red x1
Audio Out		Stereo Mini Jack x 1	
USB Interface	USB Type A	1 (for 2A Power Supply, Firmware Update and Copy OSD Setting)	1 (for Wireless LAN, Firmware Update, Copy OSD Settings)
	USB Type B	1 (for Firmware Update, Copy OSD Settings)	
Network	Wired LAN	N/A	
	Wireless	N/A	Built-In
Wireless Specifications (Wireless LAN)			
Supported Speed For Each Mode		N/A	IEEE 802.11b (2.4GHz): 11 Mbps³ IEEE 802.11g (2.4GHz): 54 Mbps³ IEEE 802.11n (2.4GHz): 72.2 Mbps³ IEEE 802.11a (5GHz): 54 Mbps³ IEEE 802.11n (5GHz): 150 Mbps³
Supported Connection Mode		N/A	Infrastructure, Access Point
Wireless LAN Security		N/A	Infrastructure: OPEN WPA2/WPA3-PSK, WPA2/WPA3-EAP Supported EAP Type: PEAP, PEAP-TLS, EAP-TLS, EAP-Fast Access Point: OPEN WPA2-PSK(AES)
Adjustment Functions			
Six Axis Colour Adjustment		N/A	N/A
Picture In Picture		N/A	N/A
Aspect Mode		Yes (Auto / 16:9 / Full / Zoom)	Yes (Auto / Normal / Full / Zoom)
Frame Interpolation		N/A	
Image Enhancement			
Image Preset Mode		N/A	
MPEG Noise Reduction		Yes	N/A
Super Resolution		N/A	
Detail Enhancement		N/A	Yes
Operating Temperature		5 - 35 °C <41 - 95 °F> (0m / 0ft - 2,286m / 7,500ft) 5 - 30 °C <41 - 86 °F> (over 2,286m / 7,500ft) [20%-80% Humidity, No Condensation]	5 - 40 °C <41 - 104 °F> (0m / 0ft - 2,286m / 7,500ft) 5 - 35 °C <41 - 95 °F> (over 2,286m / 7,500ft) [20%-80% Humidity, No Condensation]
Operating Altitude		0 m to 3,000 m <0 ft to 9,843 ft> (Over 1,500 m / 4,921 ft : with High Altitude mode)	0 m to 3,048 m <0 ft to 10,000 ft> (Over 1,500 m / 4,921 ft : with High Altitude mode)
Direct Power On/Off		Yes / No	Yes / Yes
Start-Up Period		Under 6 seconds / Warm-up period: 30 seconds	
Cool Down Period		Instant Off	
Air Filter			
Maintenance Cycle*4		5,000 H	Normal: 6,000 H / Eco: 12,000 H
Power Supply Voltage		100 - 240 V AC ±10%, 50/60 Hz	
Power Consumption (220-240V)			
Lamp On (Normal / Eco)		172W / 115W	327W / 225W
Standby (Network On / Off)		N/A / 0.4W	2.0 W / 0.3 W
Dimension Excluding Feet (D X W X H)		227 x 210 x 88 mm	249 x 302 x 87 mm
Weight		Approx. 2.7kg	Approx. 2.8kg
Fan Noise (Normal / Eco)		29dB / 26dB	37dB / 28dB

*1 Lamp life will vary depending upon mode selected, environmental conditions and usage. Lamp brightness decreases over time.

*2 Colour brightness (colour light output) and white brightness (white light output) will vary depending on usage conditions. Colour light output measured in accordance with IDMS 15:4; white light output measured in accordance with ISO 21118.

*3 These modes and actual data throughputs depend on supported wireless mode of source devices and/or environmental conditions.

*4 When used in the general office environment (the amount of floating dust: 0.04-0.2 mg/m3). Based on the Epson's in-house test results.

EpiqVision Mini EF-100B

Supplied Accessories

Power Cable: 1.8m x 1
Remote Control with 2 x AAA Battery
Quick Start Guide

Optional Accessories

Air Filter: ELPAF57
Ceiling Mount (White Colour): ELPMB60
Lighting Track Mount: ELPMB61

EF-100B



EH-TW750

Supplied Accessories

Power Cable: 1.8m x 1
Remote Control with 2 x AA Battery
Quick Start Guide

Optional Accessories

Spare Lamp: ELPLP97
Air Filter: ELPAF32
Ceiling Mount (White Colour): ELPMB23
Soft Carrying Case: ELPKS69



©2021 Epson Singapore Pte Ltd. All Rights Reserved.
Reproduction in part or in whole, without the written permission from Epson, is strictly prohibited.

EPSON and EXCEED YOUR VISION are registered trademarks of Seiko Epson Corporation.

All other product names and other company names used herein are for identification purposes only and are the trademarks or registered trademarks of their respective owners.

Epson disclaims any and all rights in those marks. Projected images shown herein are simulations. The actual product design and contents may vary. Specifications are subject to change without notice and may vary between countries. Please check with local Epson offices for more information.

Apple, iPad and iPhone are trademarks of Apple Inc., registered in the U.S. and other countries. App Store is a service mark of Apple Inc.

Android is a trademark of Google Inc.

Dealer's Stamp

Information correct at time of printing.
Printed March 2021

Find out more at www.epson.com.sg/projectors



epsonSingapore



@epsonsingapore



EpsonSoutheastAsia



Epson Singapore

Epson Singapore Pte Ltd
Epson Customer Care Center

438B Alexandra Road, Block B Alexandra Technopark, #04-01/04, Singapore 119968. Tel: (65) 6586-5500
100G Pasir Panjang Road, #01-09 Interlocal Centre, Singapore 118523. Epson Helpdesk: 800 120 5564. Please refer to www.epson.com.sg/contact for opening hours.

SPECIFICATIONS

MODEL NUMBER		EpiqVision Mini EF-11		EpiqVision Mini EF-12	
Projection Technology		RGB liquid crystal shutter projection system (3LCD)			
Specifications of Main Parts					
LCD	Size 0.62"				
	Native Resolution	Full HD (1080p)			
	Aspect Ratio	16:9			
Projection Lens (Using Optional ELPLM15)					
Type		Focus (Manual) / No Optical Zoom		Focus (Auto) / No Optical Zoom	
F-Number		2.0			
Focal Length		13.90 mm			
Zoom Ratio		1 – 1.35 (Digital Zoom)		N/A	
Throw Ratio		1 (Wide to Tele)			
Lightsource	Type	Laser Diode			
	Life (Normal / Quiet)	20,000 hours			
Screen Size (Projected Distance)					
Zoom: Wide		30" – 150" [0.6 – 3.4 m]			
Zoom: Tele		20" – 114" [0.6 – 3.4 m]			
Standard		60" screen 1.33 m			
Brightness ¹					
Colour Light Output		1,000 lm			
White Light Output (Normal / Eco)		1,000 lm / 500 lm			
Contrast Ratio					
		Over 2,500,000:1			
Internal Speaker(s)					
Sound Output		1.5W 2 Way [Mono]		5W [Stereo] Enclosure	
Geometric Correction					
Vertical / Horizontal Keystone		±34° / ±40°			
Quick Corner		Yes		N/A	
Projection Orientation		360° Free			
Connectivity					
Digital Input	HDMI	1 (HDCP1.4)		2 (HDCP2.3)	
Audio Output	Stereo Mini Jack	1 (for headphone)			
USB I/O	Type A	1 (For PC Free, Firmware Update, Copy OSD Settings, 5V/2A power supply)		1 (For USB storage, RJ45,Camera, Mic, HID)	
	Type B	1 (for Firmware Update, Copy OSD Settings)			
Wireless Specification (Screen Mirroring)					
Supported Speed For Each Mode		IEEE 802.11g (2.4GHz): 54 Mbps ² , IEEE 802.11n (2.4GHz): 130 Mbps ² , IEEE 802.11a (5GHz): 54 Mbps ² , IEEE 802.11n (5GHz): 270 Mbps ² , IEEE 802.11ac (5GHz): 780 Mbps ²		N/A	
Supported Security Type		WPA2-PSK (AES)		N/A	
Wireless Specification (Streaming Media Player Function)					
Supported Standard and Frequency		N/A		IEEE 802.11a (5GHz), IEEE 802.11b (2.4GHz), IEEE 802.11g (2.4GHz), IEEE 802.11n (2.4GHz and 5GHz), IEEE 802.11ac (5GHz)	
Supported OS		N/A		Android OS	
Supported VOD Platform		N/A		Android TV	
Video Output Resolution		N/A		Up to 1,920 x 1080, 60fps, 4:4:4	
Operating Temperature					
		Low Altitude (0 - 2,286 m / 0 - 7,500 ft): 5 - 35 °C <41 - 95 °F> [20% – 80% Humidity, No Condensation] High Altitude (Over 2,286 m / 7,500 ft): 5 - 30 °C <41 - 86 °F> [20% – 80% Humidity, No Condensation]			
Operating Altitude					
		0 - 3,000 m <0 - 9,843 ft>			
Start-Up Period					
		Less than 6 seconds. Warm-up period: 30 seconds			
Cool Down Period					
		Instant Off			
Air Filter	Maintenance Cycle	5,000 hours ³			
Power Supply Voltage					
		100 - 240 V AC ±10%, 50/60 Hz			
Power Consumption (220 - 240V)					
Laser Diode ON (Normal / Extended)		102W / 73W			
Standby (Network / Energy Saving)		N/A / 0.5 W		2.0 W / 0.5 W	
Dimension Excluding Feet (D X W X H)					
		175 x 175 x 58 mm		175 x 175 x 128 mm	
Weight					
		Approx. 1.2 kg		Approx. 2.1 kg	
Fan Noise (Normal / Eco)					
		27dB / 22dB			

¹ Colour brightness (colour light output) and white brightness (white light output) will vary depending on usage conditions. Colour light output measured in accordance with IDMS 15:4; white light output measured in accordance with ISO 21118.

² Maximum speed and range is achievable when used with same enhanced mode technology. Actual data rates, features and performance may vary depending on your computer system, the environment and other factors.

³ When used in the general office environment (the amount of floating dust: 0.04 - 0.2 mg/m³). Based on the Epson's in-house test results.

Supplied Accessories

Power Cable: 1m x 1
Remote Control with 2 x AAA Battery
Quick Start Guide

Optional Accessories

Mount Plate: ELPMB65
Air Filter: ELPAF61

EF-11



EF-12



©2021 Epson Singapore Pte Ltd. All Rights Reserved.
Reproduction in part or in whole, without the written permission from Epson, is strictly prohibited.

EPSON and EXCEED YOUR VISION are registered trademarks of Seiko Epson Corporation.

All other product names and other company names used herein are for identification purposes only and are the trademarks or registered trademarks of their respective owners.

Epson disclaims any and all rights in those marks. Projected images shown herein are simulations. The actual product design and contents may vary. Specifications are subject to change without notice and may vary between countries. Please check with local Epson offices for more information.

Apple, iPad and iPhone are trademarks of Apple Inc., registered in the U.S. and other countries. App Store is a service mark of Apple Inc.

Android is a trademark of Google Inc.

Dealer's Stamp

Information correct at time of printing.
Printed March 2021

Find out more at www.epson.com.sg/projectors



epsonSingapore



@epsonsingapore



EpsonSoutheastAsia



Epson Singapore

Epson Singapore Pte Ltd
Epson Customer Care Center

438B Alexandra Road, Block B Alexandra Technopark, #04-01/04, Singapore 119968. Tel: (65) 6586-5500
100G Pasir Panjang Road, #01-09 Interlocal Centre, Singapore 118523. Epson Helpdesk: 800 120 5564. Please refer to www.epson.com.sg/contact for opening hours.

SPECIFICATIONS

MODEL NUMBER		EH-TW5820
Projection Technology		RGB liquid crystal shutter projection system
Specifications of Main Parts		
LCD	Size	0.61" wide panel (C² Fine, 10Bit)
	Native Resolution	1080p
Projection Lens	Type	Optical Zoom (Manual) / Focus (Manual)
	F-Number	1.51 – 1.99
	Focal Length	18.2 – 29.2 mm
	Zoom Ratio	1 – 1.6
Lightsource	Throw Ratio	1.33 – 2.16 (Wide – Tele)
	Type	Lamp: 200W UHE
	Lamp Life¹	Normal: 4,500 / Eco: 7,500 hours
Screen Size (Projected Distance)		
Zoom: Wide		30" to 300" [0.87 to 8.9 m]
Zoom: Tele		30" to 300" [1.42 to 14.5 m]
Standard Size		80" screen 2.35 to 3.82 m
Brightness²		
Colour Light Output		2,700 lm
White Light Output (Normal / Eco)		2,700 lm / 1,780 lm
Contrast Ratio		70,000:1
Internal Speaker(s)		
Sound Output		10W Monaural (with enclosure)
Geometric Correction		
Vertical / Horizontal Keystone		±30° / ±30° (Slide Bar)
Auto Keystone Correction		Yes (Vertical ±30°, Zoom: Tele)
Horizontal Slide Keystone Correction		Yes
Quick Corner		Yes
Lens Shift Range		
Lens Shift		Vertical: +45% to +60%
Connectivity		
Digital Input	HDMI	1
Audio Out		Stereo Mini Jack x 1
USB Interface	USB Type B	1
Wireless Specifications (Smart Media Player Function)		
Wireless LAN		Wi-Fi 5
Supported Speed For Each Mode		IEEE 802.11a (5GHz) / IEEE 802.11b (2.4GHz) / IEEE 802.11g (2.4GHz) / IEEE 802.11n (2.4GHz and 5GHz) / IEEE 802.11ac (5GHz)³
Bluetooth		Version 5.0
Frequency Used		2.4GHz
Supported Codec		SBC
Supported OS		Android OS
Supported VOD Platform		Android TV
Video Output Resolution		Up to 3,840 x 2,160 60fps 4:4:4
Wireless Specifications (Built-in Bluetooth Unit)		
Version		Version 3.0
Communication Distance		Approx. 10m
Frequency Used		2.4GHz
Supported Codec		SBC, Qualcomm aptX Audio
Streaming Media Player		
Supported Operating System		Android 9.0. Nunai OS
Video Processing		Dolby VisionOptional, Dynamic HDR, HDR10, HLG and Technicolor HDR processing
Audio		MP3, AAC, WMA, RM, FLAC, Ogg, Dolby DigitalOptional, Dolby Digital PlusOptional, DTSOptional and programmable with 7.1/5.1 down-mixing
Adjustment Functions		
Frame Interpolation		Yes
Detail Enhancement		Yes
Aspect Mode		Yes (Auto / Normal / Full / Zoom)
3D Features		
3D Display		Yes
3D Format		Yes
3D Depth		Yes
Operating Temperature		
		5 - 35 °C <41 - 95 °F> (0m / 0ft - 2,286m / 7,500ft)
		5 - 30 °C <41 - 86 °F> (Over 2,286m / 7,500ft)
		(20% - 80% Humidity, No Condensation)
		0 m to 3,048 m <0 ft to 10,000 ft> (over 1,500 m / 4,921 ft : with High Altitude mode)
Operating Altitude		
Direct Power On / Off		Yes / N/A
Start-Up Period		
		Under 15 seconds
		Warm-up period: 30 seconds
Cool Down Period		
		Under 5 seconds
Power Supply Voltage		100 - 240 V AC ±10%, 50/60 Hz
Power Consumption (220 - 240V)		
Lamp On (Normal / Eco)		297W / 227W
Energy Saving		0.3W
Dimension Excluding Feet (D X W X H)		308 x 309 x 107 mm
Weight		Approx. 3.8kg
Fan Noise (Normal / Eco)		36dB / 28dB

¹ Lamp life will vary depending upon mode selected, environmental conditions and usage. Lamp brightness decreases over time.

² Colour brightness (colour light output) and white brightness (white light output) will vary depending on usage conditions. Colour light output measured in accordance with IDMS 15:4; white light output measured in accordance with ISO 21118.

³ These modes and actual data throughputs depend on supported wireless mode of source devices and/or environmental conditions.

Supplied Accessories

Power Cable: 3m x 1

Remote Control with 4 x AAA Battery

Optional Accessories

Spare Lamp: ELPLP97

Air Filter: ELPAF55

Ceiling Mount (White Colour): ELPMB23



©2021 Epson Singapore Pte Ltd. All Rights Reserved. Reproduction in part or in whole, without the written permission from Epson, is strictly prohibited.

EPSON and EXCEED YOUR VISION are registered trademarks of Seiko Epson Corporation.

All other product names and other company names used herein are for identification purposes only and are the trademarks or registered trademarks of their respective owners.

Epson disclaims any and all rights in those marks. Projected images shown herein are simulations. The actual product design and contents may vary. Specifications are subject to change without notice and may vary between countries. Please check with local Epson offices for more information.

Apple, iPad and iPhone are trademarks of Apple Inc., registered in the U.S. and other countries. App Store is a service mark of Apple Inc.

Android is a trademark of Google Inc.

Dealer's Stamp

Information correct at time of printing.
Printed February 2021

Find out more at www.epson.com.sg/projectors



epsonSingapore



@epsongsingapore



EpsonSoutheastAsia



Epson Singapore

Epson Singapore Pte Ltd
Epson Customer Care Center

438B Alexandra Road, Block B Alexandra Technopark, #04-01/04, Singapore 119968. Tel: (65) 6586-5500
100G Pasir Panjang Road, #01-09 Interlocal Centre, Singapore 118523. Epson Helpdesk: 800 120 5564. Please refer to www.epson.com.sg/contact for opening hours.

SPECIFICATIONS

MODEL NUMBER		EH-TW7000
Projection Technology		RGB liquid crystal shutter projection system (3LCD)
Specifications of Main Parts		
LCD	Size	0.61" wide panel (C ² Fine)
	Native Resolution	1080p
Projection Lens		
	Type	Optical Zoom (Manual) / Focus (Manual)
	F-Number	1.49 – 1.77
	Focal Length	18.2 – 29.2 mm
	Zoom Ratio	1 – 1.62
	Throw Ratio (Wide – Tele)	1.32 – 2.15
Lightsource	Type	Lamp: 250W UHE
	Lamp Life*1	High: 3,500 / Medium: 4,000 / Eco: 5,000 hours
Screen Size (Projected Distance)		
Zoom: Wide		40" to 500" [1.16 to 14.87 m]
Zoom: Tele		40" to 500" [1.89 to 24.01 m]
Standard Size		100" screen 2.95 to 4.77 m
Brightness*2		
Colour Light Output		3,000 lm
White Light Output (Normal / Eco)		3,000 lm / 2,000 lm
Contrast Ratio		40,000:1
Geometric Correction		
Vertical / Horizontal Keystone		±30° / ±30°
Image Enhancement		
4K Enhancement		Yes (On/Off)
Picture In Picture		N/A
Aspect Mode		Yes (Auto / Normal / Full / Zoom)
Frame Interpolation		Off / Low / Normal / High (2D and 3D Mode)
Image Preset Mode		Yes
MPEG Noise Reduction		Yes
Super Resolution		Yes
Detail Enhancement		Yes
3D Features		
3D Display		Yes
2D – 3D Conversion		N/A
3D Format		Side by Side / Top and Bottom
3D Depth		-10 to +10
Connectivity		
Analog Input	D-Sub 15Pin	N/A
	5BNC	N/A
Digital Input	DVI-D	N/A
	HDMI	2 (HDCP 2.2)
Output Terminal	D-Sub 15Pin	N/A
Audio Input	Stereo Mini Jack	N/A
Audio Output	Stereo Mini Jack	1
Others	USB Type A	2
		(Port1: Wireless LAN, Firmware Update, Copy OSD Settings) (Port 2: For Streaming Media Player with 2,000 mA Power Supply)
Control I/O	USB Type Mini-B	1 (For Firmware Update)
	RS-232C	N/A
Network	Remote Control Input	NA
	Wired LAN	N/A
	Wireless	Optional (ELPAP10)
Wireless Specification		
Supported Connection Mode		Infrastructure, Access Point
Supported Speed For Each Mode		IEEE 802.11b (2.4GHz): 11 Mbps ³
		IEEE 802.11g (2.4GHz): 54 Mbps ³
		IEEE 802.11n (2.4GHz): 130.0 Mbps ³
Wireless LAN Security		Quick Mode: WPA2-PSK
		Advanced Mode: WPA/WPA2-PSK
Operating Temperature		5 - 35 °C <41 - 95 °F> (0m / 0ft - 2,286m / 7,500ft) 5 - 30 °C <41 - 86 °F> (Over 2,286m / 7,500ft) (20% - 80% Humidity, No Condensation)
Operating Altitude		0 m to 3,048 m <0 ft to 10,000 ft>
Direct Power On / Off		Yes / N/A
Start-Up Period		Up to 19 seconds, Warm-up Period: 30 seconds
Cool Down Period		Up to 7 seconds
Power Supply Voltage		100 - 240 V AC ±10%, 50/60 Hz
Power Consumption (220 - 240V)		
Lamp (Normal / Eco)		368W / 280W
Standby (Network On / Off)		2.0W (Optional Wireless LAN) / 0.5 W
Dimension Excluding Feet (D X W X H)		310 x 410 x 157 mm
Weight (Including Standard Lens)		Approx. 6.6 kg
Fan Noise (Normal / Eco)		35dB / 24dB

*1 Lamp life will vary depending upon mode selected, environmental conditions and usage. Lamp brightness decreases over time.

*2 Colour brightness (colour light output) and white brightness (white light output) will vary depending on usage conditions. Colour light output measured in accordance with IDMS 15:4; white light output measured in accordance with ISO 21118.

*3 These modes and actual data throughputs depend on supported wireless mode of source devices and/or environmental conditions.

EH-TW7000

Supplied Accessories

Power Cable: 3m x 1
Remote Control with 2 x AA Battery
User Manual CDROM
Quick Start Guide

Optional Accessories

Spare Lamp: ELPLP85
Air Filter: ELPAF39
Wireless LAN unit: ELPAP10
Ceiling Mount: ELPLMB22



©2021 Epson Singapore Pte Ltd. All Rights Reserved. Reproduction in part or in whole, without the written permission from Epson, is strictly prohibited.

EPSON and EXCEED YOUR VISION are registered trademarks of Seiko Epson Corporation.

All other product names and other company names used herein are for identification purposes only and are the trademarks or registered trademarks of their respective owners.

Epson disclaims any and all rights in those marks. Projected images shown herein are simulations. The actual product design and contents may vary. Specifications are subject to change without notice and may vary between countries. Please check with local Epson offices for more information.

Apple, iPad and iPhone are trademarks of Apple Inc., registered in the U.S. and other countries. App Store is a service mark of Apple Inc.

Android is a trademark of Google Inc.

Dealer's Stamp

Information correct at time of printing.
Printed February 2021

Find out more at www.epson.com.sg/projectors



epsonSingapore



@epsonsingapore



EpsonSoutheastAsia



Epson Singapore

Epson Singapore Pte Ltd
Epson Customer Care Center

438B Alexandra Road, Block B Alexandra Technopark, #04-01/04, Singapore 119968. Tel: (65) 6586-5500
100G Pasir Panjang Road, #01-09 Interlocal Centre, Singapore 118523. Epson Helpdesk: 800 120 5564. Please refer to www.epson.com.sg/contact for opening hours.

SPECIFICATIONS

MODEL NUMBER		EpiqVision Ultra EH-LS300B	EpiqVision Ultra EH-LS500B
Projection Technology		RGB liquid crystal shutter projection system (3LCD)	
Specifications of Main Parts			
LCD	Size	0.61" (C ² Fine)	
	Native Resolution	1080p	
	Aspect Ratio	16:9	
Projection Lens			
Type		No Optical Zoom / Focus (Manual)	
F-Number		1.6	1.5
Focal Length		3.7 mm	3.99 mm
Zoom Ratio		N/A	1 – 1.35 (Digital Zoom)
Throw Ratio (Wide – Tele)		0.26	0.28 – 0.38
Lightsource	Type	Laser Diode	
	Life	20,000 hours (Normal / Quiet)	20,000 hours (Normal / Eco)
Screen Size (Projected Distance)			
Zoom: Wide		61" to 120" [0.349 to 0.703 m]	65" to 130" [0.398 to 0.817 m]
Zoom: Tele		N/A	48" to 96" [0.398 to 0.817 m]
Standard Size		75.9" screen 0.443 m	80" screen 0.495 m
Brightness ^{*1}			
Colour Light Output		3,600 lm	4,000 lm
White Light Output (Normal / Eco)		3,600 lm / 1,800 lm	4,000 lm / 1,200 lm
Contrast Ratio		Over 2,500,000:1	
Geometric Correction			
Vertical / Horizontal Keystone		N/A / N/A	±3° / ±3°
Internal Speakers			
Sound Output		20W (2.1ch Satellite x2, Woofer x1)	10W x2 (Stereo)
Image Enhancement			
4K Enhancement		N/A	Yes (On/Off)
Aspect Mode		Yes (Auto / Normal / Full / Zoom)	
Frame Interpolation		N/A	Yes (Off / Low / Normal / High [2D and 3D Mode])
Image Preset Mode		N/A	Yes
Noise Reduction		Yes	
Detail Enhancement		Yes	
Super Resolution		N/A	Yes
3D Display		N/A	Yes
Connectivity			
Digital Input	HDMI	2 (SMF, HDMI2=ARC)	3 (HDCP 2.2)
	Audio Output	Stereo Mini Jack	
	Others	USB Type A	Yes (For USB Storage, RJ45, Camera, Mic, HID)
			1 (For Saving and Reading via USB Memory, USB Document Camera, Firmware Update and Copy OSD Settings)
		USB Type Mini-B	1 (For Firmware Update)
Control I/O	RS-232C	N/A	D-sub 9pin x1
Network	Wired LAN	N/A	RJ45 x 1
	Wireless	Yes (Only for Smart Media Player)	Optional (ELPAP10)
Wireless Specification			
Supported Connection Mode		N/A	Infrastructure, Access Point
Supported Speed For Each Mode		N/A	IEEE 802.11b (2.4GHz): 11 Mbps ² IEEE 802.11g (2.4GHz): 54 Mbps ² IEEE 802.11n (2.4GHz): 130.0 Mbps ²
Wireless LAN Security		N/A	Quick Mode: OPEN, WPA2-PSK Advanced Mode: OPEN, WPA/WPA2-PSK, WPA/WPA2-EAP Supported EAP type: PEAP, PEAP-TLS, EAP-TLS, EAP-Fast, LEAP
Wireless Specification (Smart Media Player Function)			
Wireless LAN		Wi-Fi 5	N/A
Supported Speed For Each Mode		IEEE 802.11a (5GHz) ² , IEEE 802.11b (2.4GHz) ² , IEEE 802.11g (2.4GHz) ² , IEEE 802.11n (2.4GHz and 5GHz) ² , IEEE 802.11ac (5GHz) ²	N/A
Bluetooth		Bluetooth 5.0 Class 2 (2.4GHz)	N/A
Supported OS		Android OS	N/A
Supported VOD Platform		Android TV	N/A
Video Output Resolution		Up to 1,920 x 1,080 60fps at 4:4:4	N/A
Operating Temperature			
		0 - 35 °C <41 - 95 °F> (0m / 0ft - 2,286m / 7,500ft) 0 - 30 °C <41 - 86 °F> (Over 2,286m / 7,500ft) (20% - 80% Humidity, No Condensation)	5 - 35 °C <41 - 95 °F> (0m / 0ft - 2,286m / 7,500ft) 5 - 30 °C <41 - 86 °F> (Over 2,286m / 7,500ft) (20% - 80% Humidity, No Condensation)
Operating Altitude		0 m to 3,048 m <0 ft to 10,000 ft> Over 1,500m / 4,921 ft, with High Altitude mode	
Start-Up Period		Less than 6 seconds	Less than 7 seconds, Quick startup: Less than 9 seconds Warm-up period: 30 seconds
Cool Down Period		Instant Off	
Power Supply Voltage		100 - 240 V AC ±10%, 50/60 Hz	
Power Consumption (220 - 240V)			
Lamp (Normal / Eco)		278W / 179W	366W / 230W
Standby (Network On / Off)		2.0W / 0.5 W	
Dimension Excluding Feet (D X W X H)		400 x 467 x 133 mm	375 x 458 x 209.5 mm
Weight (Including Standard Lens)		Approx. 7.2 kg	Approx. 9.3 kg
Fan Noise (Normal / Eco)		37dB / 23dB	36dB / 23dB

^{*1} Colour brightness (colour light output) and white brightness (white light output) will vary depending on usage conditions. Colour light output measured in accordance with IDMS 15:4; white light output measured in accordance with ISO 21118.

^{*2} These modes and actual data throughputs depend on supported wireless mode of source devices and/or environmental conditions.

EpiqVision Ultra EH-LS300B

Supplied Accessories

Power Cable: 1.8m x 1
Remote Control with 2 x AAA Battery
Quick Start Guide

Optional Accessories

Air Filter: ELPAF60
ALR Screen: ELPSC35



EpiqVision Ultra EH-LS500B

Supplied Accessories

Power Cable: 1.8m x 1
HDMI Extension Cable
USB Power cable
Remote Control with 2 x AAA Battery
Lens Cap
Main Unit Foot

Optional Accessories

Air Filter: ELPAF56
Wireless LAN: ELPAP10



©2021 Epson Singapore Pte Ltd. All Rights Reserved.
Reproduction in part or in whole, without the written permission from Epson, is strictly prohibited.

EPSON and EXCEED YOUR VISION are registered trademarks of Seiko Epson Corporation.

All other product names and other company names used herein are for identification purposes only and are the trademarks or registered trademarks of their respective owners.

Epson disclaims any and all rights in those marks. Projected images shown herein are simulations. The actual product design and contents may vary. Specifications are subject to change without notice and may vary between countries. Please check with local Epson offices for more information.

Apple, iPad and iPhone are trademarks of Apple Inc., registered in the U.S. and other countries. App Store is a service mark of Apple Inc.

Android is a trademark of Google Inc.

Dealer's Stamp

Information correct at time of printing.
Printed March 2021

Find out more at www.epson.com.sg/projectors



epsonSingapore



@epsongsingapore



EpsonSoutheastAsia



Epson Singapore

Epson Singapore Pte Ltd
Epson Customer Care Center

438B Alexandra Road, Block B Alexandra Technopark, #04-01/04, Singapore 119968. Tel: (65) 6586-5500
100G Pasir Panjang Road, #01-09 Interlocal Centre, Singapore 118523. Epson Helpdesk: 800 120 5564. Please refer to www.epson.com.sg/contact for opening hours.

SPECIFICATIONS

MODEL NUMBER	EH-TW7400		EH-TW9400
Projection Technology	RGB liquid crystal shutter projection system		
Specifications of Main Parts			
LCD	Size	0.74" wide panel with MLA (C ² Fine, 12 bit, OD)	
	Native Resolution	1080p	
Projection Lens	Type	Power Zoom, Power Focus	
	F-Number	2.0 – 3.0	
	Focal Length	22.5 – 46.7 mm	
	Zoom Ratio	1 – 2.1	
	Throw Ratio	1.35 – 2.84	
Lightsources	Type	Lamp: 250 W UHE	
	Lamp Life* ¹	High: 3,500 / Medium: 4,000 / Eco: 5,000 hours	
Screen Size (Projected Distance)			
Zoom: Wide	50" to 300" [1.48 to 9.08 m]		
Zoom: Tele	50" to 300" [3.13 to 18.99 m]		
Standard Size	100" screen 3.00 to 6.30 m		
Brightness²			
Colour Light Output	2,400 lm	2,600 lm	
White Light Output (Normal / Eco)	2,400 lm / 590 lm	2,600 lm / 640 lm	
Contrast Ratio	200,000:1	1,200,000:1	
Geometric Correction			
Vertical Keystone	±30 degrees		
Lens Shift Range			
Vertical Lens Shift	±96.3 % (H Center, Powered)		
Horizontal Lens Shift	±47.1 % (V Center, Powered)		
Connectivity			
Analog Input	D-Sub 15Pin	1 (Blue)	
Digital Input	HDMI	2 (HDMI 1 - HDCP 2.2, HDMI 2 - HDCP 1.4) 2 (HDCP 2.2)	
USB Interface	USB Type A	2 (Right USB: Wireless LAN, Firmware Update, Copy OSD Settings) (Left USB: Opt. HDMI cable with 300mA power supply)	
	USB Type B	USB Mini-B x 1 (For Service and Firmware Update)	
Control I/O	RS-232C	D-Sub 9pin x 1	
	Trigger Out (12V)	3.5mm Mini Jack x 1	
Network	Wired LAN	RJ45 x 1	
	Wireless	Optional (ELPAP10)	
Wireless Specifications (Wireless LAN)			
Supported Speed For Each Mode	IEEE 802.11b (2.4GHz): 11 Mbps ³ IEEE 802.11g (2.4GHz): 54 Mbps ³ IEEE 802.11n (2.4GHz): 130 Mbps ³		
Supported Connection Mode	Infrastructure, Access Point		
Wireless LAN Security	Quick Mode: OPEN, WPA2-PSK Advanced Mode: OPEN, WPA/WPA2-PSK		
Adjustment Functions			
Picture In Picture	Yes	N/A	
Aspect Mode	Yes (Auto / Normal / Full / Zoom)	Yes (Auto / Normal / Full / Zoom / Anamorphic Wide / Horiz.Squeeze)	
Frame Interpolation	Off / Low / Normal /High (2D and 3D Mode)		
Image Enhancement			
Image Preset Mode	Yes (Off / Preset1 / Preset2 / Preset3 / Preset4 / Preset5)		
MPEG Noise Reduction	Yes		
Super Resolution	Yes (Fine line adjust / Soft focus detail)		
Detail Enhancement	Yes (Range / Strength)		
3D Features			
3D Display	Yes (Auto / 3D / 2D)		
2D - 3D Conversion	Yes (Off / Weak / Medium / Strong)		N/A
3D Format	Side by Side / Top and Bottom		
3D Depth	-10 to +10		
Operating Temperature			
	5 - 35 °C <41 - 95 °F> (0m / 0ft - 2286m / 7,500ft) 5 - 30 °C <41 - 86 °F> (Over 2,286m / 7,500ft) 20% - 80% Humidity, No Condensation		
Operating Altitude			
	0 m to 3,048 m <0 ft to 10,000 ft> (over 1,500 m / 4,921 ft : with High altitude mode)		
Direct Power On / Off			
	Yes / NA		
Start-Up Period			
	19 seconds Warm-up period: 30 seconds		
Cool Down Period			
	16 seconds		
Power Supply Voltage			
	100 - 240 V AC +/- 10%, 50/60 Hz		
Power Consumption (220 - 240V)			
Lamp On (Normal / Eco)	355W / 271W		
Standby (Network On / Off)	2W / 0.3W		
Dimension Excluding Feet (D X W X H)			
	450 x 520 x 170 mm		
Weight			
	Approx. 11.2 kg		
Fan Noise (Normal / Eco)			
	31 dB / 20dB		

*¹ Lamp life will vary depending upon mode selected, environmental conditions and usage. Lamp brightness decreases over time.

*² Colour brightness (colour light output) and white brightness (white light output) will vary depending on usage conditions. Colour light output measured in accordance with IDMS 15:4; white light output measured in accordance with ISO 21118.

*³ These modes and actual data throughputs depend on supported wireless mode of source devices and/or environmental conditions.

Supplied Accessories

Power Cable: 3m x 1
Remote Control with 2 x AA Battery
HDMI Cable Clamp: 2

Optional Accessories

Spare Lamp: ELPLP89
Air Filter: ELPAF39
Wireless LAN Unit: ELPAP10
Ceiling Mount: ELPMB22
Cable Cover: ELPCC05W, ELPCC05B

EH-TW7400



EH-TW9400



©2021 Epson Singapore Pte Ltd. All Rights Reserved. Reproduction in part or in whole, without the written permission from Epson, is strictly prohibited.

EPSON and EXCEED YOUR VISION are registered trademarks of Seiko Epson Corporation.

All other product names and other company names used herein are for identification purposes only and are the trademarks or registered trademarks of their respective owners.

Epson disclaims any and all rights in those marks. Projected images shown herein are simulations. The actual product design and contents may vary. Specifications are subject to change without notice and may vary between countries. Please check with local Epson offices for more information.

Apple, iPad and iPhone are trademarks of Apple Inc., registered in the U.S. and other countries. App Store is a service mark of Apple Inc.

Android is a trademark of Google Inc.

Dealer's Stamp

Information correct at time of printing.
Printed March 2021



DEBUNKING THE MYTHS ABOUT HOME PROJECTORS

MYTH
1

A television is just as good as a projector.

TRUTH

It is much less stressful on your eyes from a projection screen than the television screen thanks to a more gentle light reflection. Plus, you get to experience the same thrilling big-screen experience in the comfort of your own home.



MYTH
4

I need a blank wall.

TRUTH

You could easily have a pull-down screen or a portable screen that can be kept away when it is not in use.



MYTH
2

Projectors and its maintenance are expensive.

TRUTH

Depending on your needs, you can choose between laser or lamp projectors, and before you know it, you have your money back from saving all those trips to the cinema with our wallet-friendly home projectors! Also, expensive lamps replacements are a thing of the past. With a laser light hours of up to 20,000 hours, you can indulge in a 5-hour movie marathon daily for more than 10 years.



MYTH
5

A dark room is needed.

TRUTH

Dark or bright room, you can still enjoy the show with our range of home projectors thanks to its white and colour brightness of up to 4,000 lumens!



MYTH
3

A projection screen is too big for your home?

TRUTH

You can easily adjust the screen size from 60-inches to more than 100-inches, placing our home projectors at a distance of 0.26m to 3m from the wall.



MYTH
6

Troublesome installation.

TRUTH

Simply turn on the power and be entertained instantly by the built-in Android TV on your smart projector.

